



TASSALINI

SINCE 1922, PRECISION MADE GREAT

SPRAYBALLS
CATALOG



SPRAYBALLS

TASSALINI
SINCE 1922,
PRECISION MADE GREAT



INDEX

Intro	3
Model types	4
New Sprayballs diameter 20	6
New Sprayballs diameter 75	8
Other models	12
Maintenance and Warranty	17

SPRAYBALLS

The fixed sprayballs are simple, efficient objects that can be easily cleaned. That's why they are applied to many tanks used in the food, beverage, chemical and pharmaceutical industry.

They are particularly useful in small tanks and in processes where water-soluble liquids need to be eliminated. They are built using stainless AISI 316 steel and provide high quality surface finishing (either satinized or polished).

Our sprayballs' characteristics can satisfy any possible specific need, and can be equipped with different kinds of couplings or clips that allow to easily disassemble and clean them.



MODEL TYPES

The sprayballs come in four different models: "A", "B", "C", "D" and in different couplings: gas thread or clip.

Available couplings:

FEMALE GAS THREAD

CLIP 22X20

CLIP 28X26

CLIP 32X30

CLIP 38X36

CLIP 40,5X38,5

CLIP 60,3X52,8

CLIP 42.4x1.6

Sub-models "J" have smaller (1,6) holes and can be applied to types 1, 2, 3, 6, 7.

Sub-models "X" have a "shoulder" in order to wash parallel to the base and can be applied to all types of balls, even creating "XJ" models. They have the same measures as the normal sprayballs.

Sprayballs with diameter of 65, 50, 90 are 10/10 thick, those with diameter 120 are 12/10 thick, and those with diameter of 40 and 28 are 8/10 thick.

They can also be built upon customer's design.



SPRAYBALLS



MODEL "A"



MODEL "B"



MODEL "C"



MODEL "D"

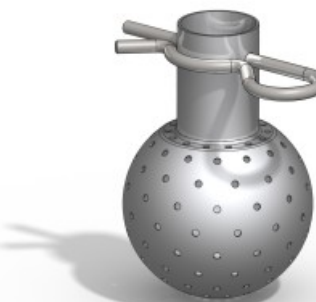

MODEL "1AX"



MODEL "1AJ"

NEW SPRAYBALLS DIAMETER 20

Pressure (Bar)		0,5	1	Spray Pattern	Wetting radius (m)	Couplings
Code	Ød mm	flow rate (lt/h)				
20A10	1	390	500	360°	0,5±1	Weld
20A16	1,6	510	640	360°	0,5±1	Weld

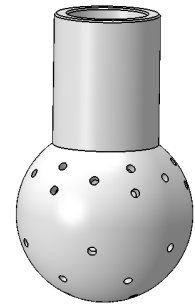
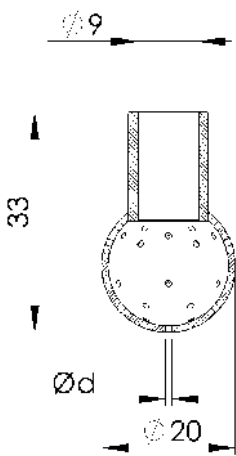

Pressure (Bar)		0,5	1	Spray Pattern	Wetting radius (m)	Couplings
Code	Ød mm	flow rate (lt/h)				
20B10	1	273	350	180°↑	0,5±1	Weld
20B16	1,6	357	448	180°↑	0,5±1	Weld

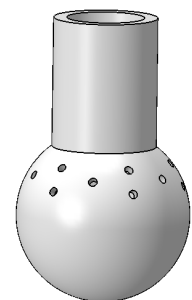
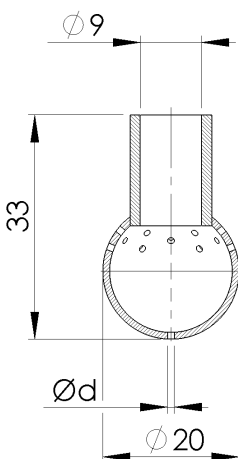

NEW SPRAYBALLS DIAMETER 20

Pressure (Bar)		0,5	1	Spray Pattern	Wetting radius (m)	Couplings
Code	Ød mm	flow rate (lt/h)				
20C10	1	312	400	180°↓	0,5±1	Weld
20C16	1,6	408	512	180°↓	0,5±1	Weld

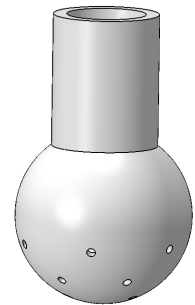
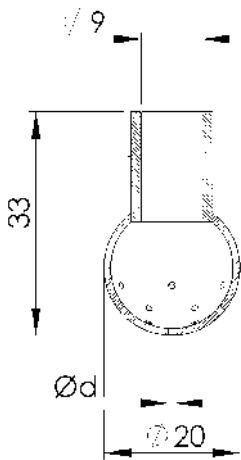

Pressure (Bar)		0,5	1	Spray Pattern	Wetting radius (m)	Couplings
Code	Ød mm	flow rate (lt/h)				
20D10	1	312	400	180°→	0,5±1	Weld
20D16	1,6	408	512	180°→	0,5±1	Weld

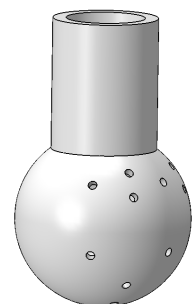
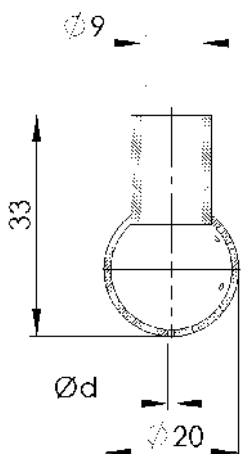

NEW SPRAYBALLS DIAMETER 75

Pressure (Bar)		1	2	3	Spray Pattern	Wetting radius (m)	Couplings
Code	Ød mm	flow rate (lt/h)					
18A16	1,6	6260	8684	10664	360°	1,5±1,8	Female thread 3/4"G BSPT
18A20	2	7660	10772	13168	360°	1,5±1,8	Female thread 3/4"G BSPT
18A25	2,5	8504	11896	14660	360°	1,5±1,8	Female thread 3/4"G BSPT

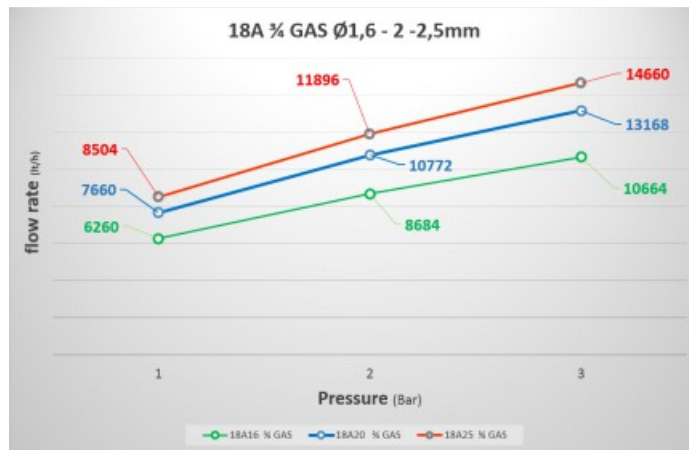
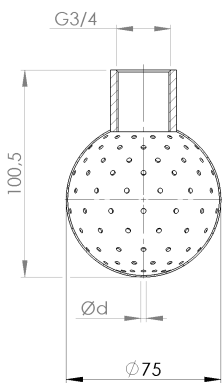

Pressure (Bar)		1	2	3	Spray Pattern	Wetting radius (m)	Couplings
Code	Ød mm	flow rate (lt/h)					
18B16	1,6	3932	5252	6712	180°↑	1,2±1,4	Female thread 3/4"G BSPT
18B20	2	5608	7376	9820	180°↑	1,2±1,4	Female thread 3/4"G BSPT
18B25	2,5	7164	9932	12236	180°↑	1,2±1,4	Female thread 3/4"G BSPT

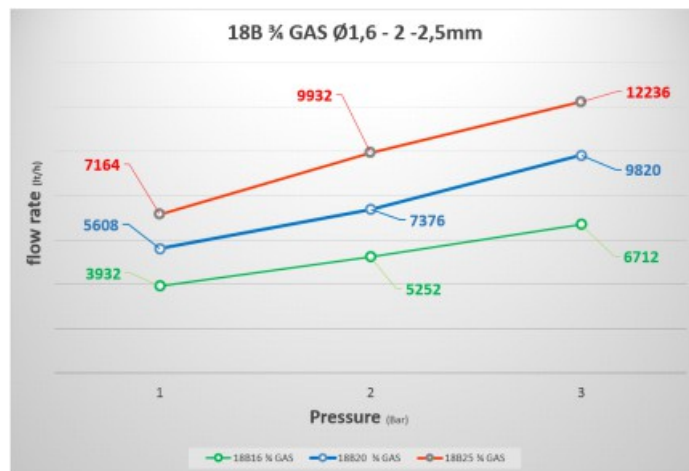
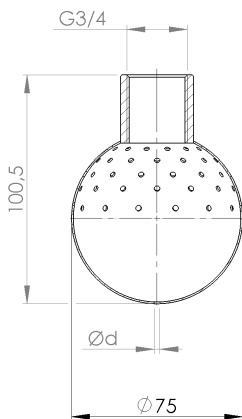

NEW SPRAYBALLS DIAMETER 75

Pressure (Bar)		1	2	3	Spray Pattern	Wetting radius (m)	Couplings
Code	Ød mm	flow rate (lt/h)					
18C16	1,6	3932	5252	6712	180°↓	1,2÷1,4	Female thread 3/4"G BSPT
18C20	2	5608	7376	9820	180°↓	1,2÷1,4	Female thread 3/4"G BSPT
18C25	2,5	7164	9932	12236	180°↓	1,2÷1,4	Female thread 3/4"G BSPT

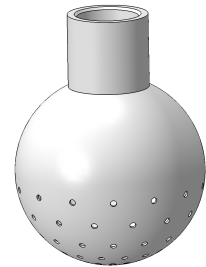
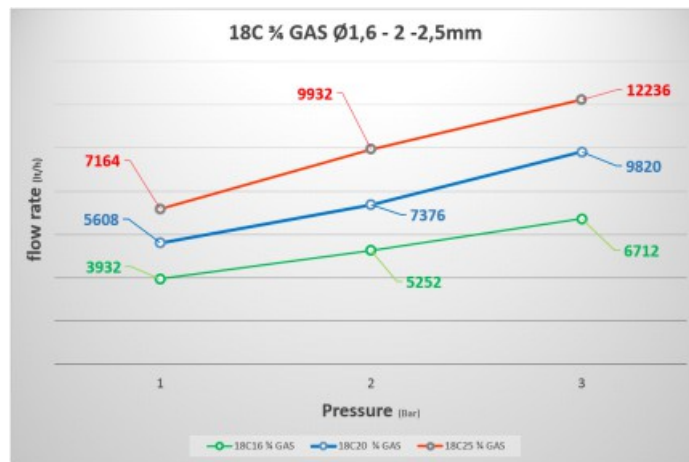
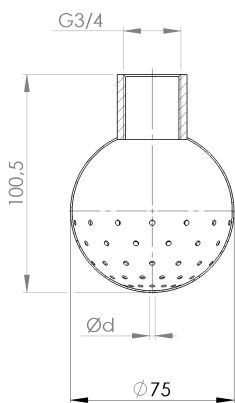

Pressure (Bar)		1	2	3	Spray Pattern	Wetting radius (m)	Couplings
Code	Ød mm	flow rate (lt/h)					
18D16	1,6	4224	5788	7192	180°→	1,2÷1,4	Female thread 3/4"G BSPT
18D20	2	5948	8128	10196	180°→	1,2÷1,4	Female thread 3/4"G BSPT
18D25	2,5	7344	10256	12652	180°→	1,2÷1,4	Female thread 3/4"G BSPT

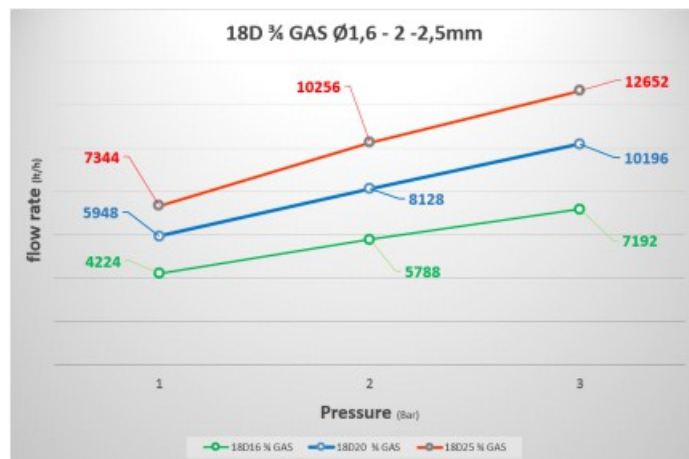
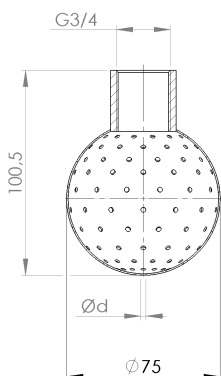

NEW SPRAYBALLS DIAMETER 75

Pressure (Bar)		1	2	3	Spray Pattern	Wetting radius (m)	Couplings
Code	Ød mm	flow rate (lt/h)					
19A16	1,6	7148	9700	11844	360°	1,6÷2,1	Female thread 1"G BSPT
19A20	2	10824	16356	18860	360°	1,6÷2,1	Female thread 1"G BSPT
19A25	2,5	15496	21408	23284	360°	1,6÷2,1	Female thread 1"G BSPT

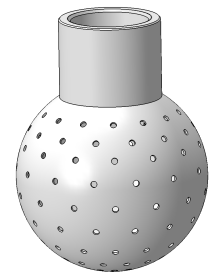
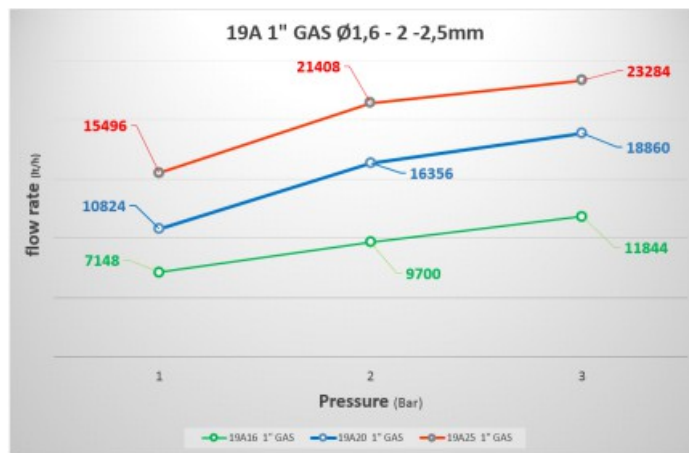
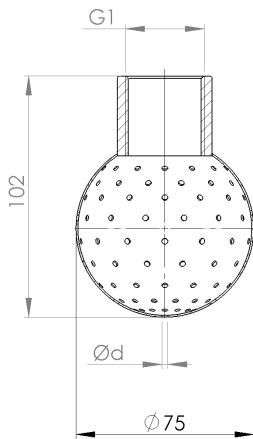

Pressure (Bar)		1	2	3	Spray Pattern	Wetting radius (m)	Couplings
Code	Ød mm	flow rate (lt/h)					
19B16	1,6	3476	4900	5948	180°↑	1,4÷1,6	Female thread 1"G BSPT
19B20	2	5252	7372	9028	180°↑	1,4÷1,6	Female thread 1"G BSPT
19B25	2,5	8072	11468	12888	180°↑	1,4÷1,6	Female thread 1"G BSPT

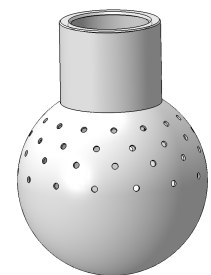
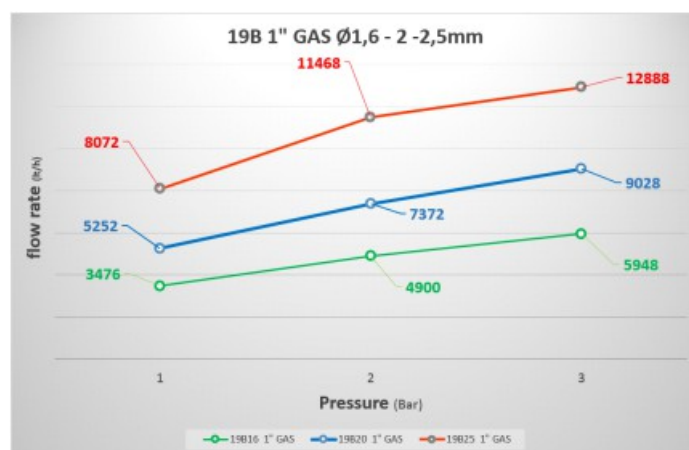
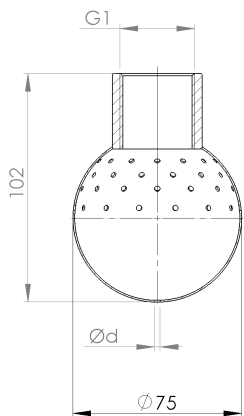

NEW SPRAYBALLS DIAMETER 75

Pressure (Bar)		1	2	3	Spray Pattern	Wetting radius (m)	Couplings
Code	Ød mm	flow rate (lt/h)					
19C16	1,6	3932	5252	6712	180°↓	1,4÷1,6	Female thread 1"G BSPT
19C20	2	5608	7376	9820	180°↓	1,4÷1,6	Female thread 1"G BSPT
19C25	2,5	7164	9932	12236	180°↓	1,4÷1,6	Female thread 1"G BSPT

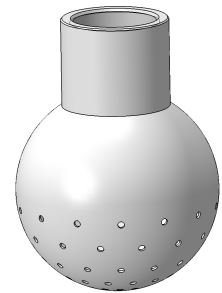
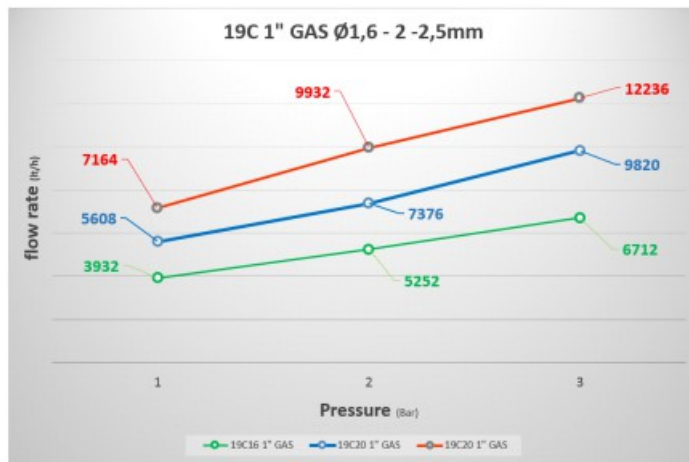
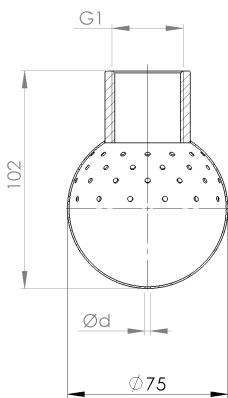

Pressure (Bar)		1	2	3	Spray Pattern	Wetting radius (m)	Couplings
Code	Ød mm	flow rate (lt/h)					
19D16	1,6	3932	5252	6712	180°→	1,4÷1,6	Female thread 1"G BSPT
19D20	2	5608	7376	9820	180°→	1,4÷1,6	Female thread 1"G BSPT
19D25	2,5	7164	9932	12236	180°→	1,4÷1,6	Female thread 1"G BSPT

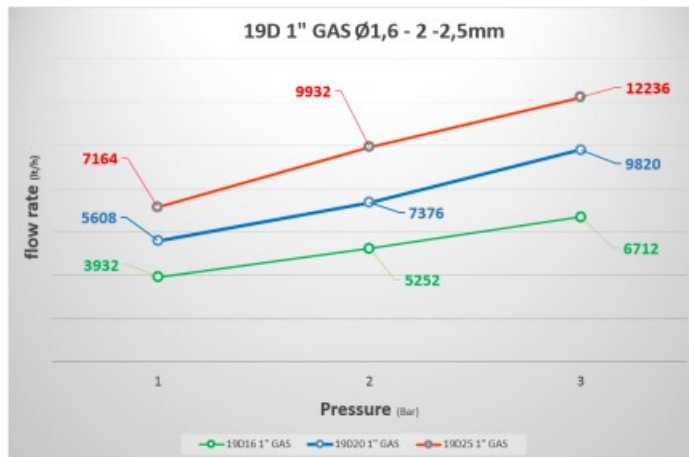
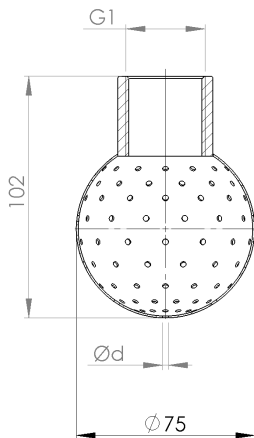

SPRAYBALLS

Female gas thread

Type	Diam (mm)	Coupl. inches	Holes diam (mm)	Capacity with different Pressure m ³ /h bar				Range (m)				H (mm) Sprayball plus coupling	No of holes
				1.0	1.5	2.0	2.5	1.0	1.5	2.0	2.5		
17A	28	¼	1.3	1.80	2.3	2.6	2.9	1,0	1,5	2,0	2,6	40	71
17B	28	¼	1.3	1.20	1.5	1.7	1.9	1,6	2,4	3,2	4,2	40	31
17C	28	¼	1.3	1.40	1.8	2,0	2,3	2,2	3,3	4,4	5,7	40	41
17D	28	¼	1.3	1.40	1.8	2,0	2,3	2,3	3,5	4,6	6,0	40	40
9A	50	½	1.6	5.40	6,6	7,7	8,6	2,4	3,6	4,8	6,0	74	81
9B	50	½	1.6	3.00	3,7	4,3	4,8	3,0	4,5	6,0	7,5	74	41
9C	50	½	1.6	3.10	3,8	4,4	4,9	3,2	4,8	6,4	8,0	74	41
9D	50	½	1.6	3.30	4,0	4,7	5,3	3,6	5,4	7,2	9,0	74	45
3A	65	¾	2.5	12,9	15,8	18,2	20,4	1,2	1,9	2,5	3,1	94	121
3B	65	¾	2.5	8.70	10,4	12,0	13,4	2,2	3,2	4,2	5,2	94	61
3C	65	¾	2.5	9.20	11,0	12,7	14,2	2,5	3,7	4,8	6,0	94	61
3D	65	¾	2.5	9.2	11,0	12,7	14,2	2,5	3,7	4,8	6,0	94	66
11A	90	1 ¼	2.5	29.8	38,7	44,7	50,0	3,1	5,2	6,9	8,7	128	177
11B	90	1 ¼	2.5	12.7	16,5	19,1	21,3	2,2	3,7	4,9	6,2	128	81
11C	90	1 ¼	2.5	15.9	20,6	23,9	26,7	3,4	5,7	7,6	9,5	128	97
11D	90	1 ¼	2.5	15.9	20,6	23,9	26,7	3,1	5,2	6,9	8,7	128	94

SPRAYBALLS

Clip coupling 22.0x20.0

Type	Diam (mm)	Coupl. Ext/Int	Holes diam (mm)	Capacity with different Pressure m ³ /h bar				Range (m)				H (mm) Sprayball plus coupling	No of holes
				1.0	1.5	2.0	2.5	1.0	1.5	2.0	2.5		
8A	50	22X20	1.6	5.55	6,8	7,9	8,8	2,5	3,8	5,1	6,4	76	81
8B	50	22X20	1.6	3.40	4,2	4,9	5,4	3,8	5,8	7,8	9,7	76	41
8C	50	22X20	1.6	3.20	4,0	4,6	5,1	3,4	5,2	6,9	8,7	76	41
8D	50	22X20	1.6	3.5	4,3	5,0	5,6	4,1	6,2	8,4	10,5	76	45
15A	40	22X20	1.6	3.7	4,6	5,3	6,0	3,8	5,8	7,7	9,6	65	49
15B	40	22X20	1.6	2.3	2,9	3,3	3,7	5,5	8,4	11,1	13,9	65	25
15C	40	22X20	1.6	2.3	2,9	3,3	3,7	5,9	9,0	12,0	14,9	65	25
15D	40	22X20	1.6	2.4	3,0	3,4	3,9	6,1	9,3	12,4	15,4	65	28
16A	40	22X20	1.3	5.1	6,3	7,2	8,1	4,7	7,1	9,5	11,8	65	109
16B	40	22X20	1.3	3.0	3,7	4,2	4,8	6,4	9,7	12,9	16,1	65	64
16C	40	22X20	1.3	3.10	3.80	4,4	4,9	7,0	10,6	14,1	17,6	65	46
16D	40	22X20	1.3	3.10	3.80	4,4	4.90	7,1	10,7	14,4	17,8	65	57

SPRAYBALLS

Clip coupling 28.0x26.0

Type	Diam (mm)	Coupl. Ext/Int	Holes diam (mm)	Capacity with different Pressure m3/h bar				Range (m)				H (mm) Sprayball plus coupling	No of holes
				1.0	1.5	2.0	2.5	1.0	1.5	2.0	2.5		
1A	65	28X26	2.5	15.8	19,3	22,3	25	1,8	2,8	3,7	4,6	91	121
1B	65	28X26	2.5	10.2	12,5	14,4	16,1	3,0	4,7	6,2	7,7	91	61
1C	65	28X26	2.5	10,5	12,8	14,8	16,6	3,2	5,0	6,6	8,2	91	61
1D	65	28X26	2.5	10.1	12,3	14,3	16,0	2,9	4,5	6,0	7,4	91	66
10A	50	28X26	1.6	7.20	8,9	10,3	11,5	4,3	6,5	8,6	10,8	76	81
10B	50	28X26	1.6	4.70	5,8	6,7	7,5	7,2	10,9	14,4	18,1	76	41
10C	50	28X26	1.6	4.70	5,8	6,7	7,5	7,2	10,9	14,4	18,1	76	41
10D	50	28X26	1.6	4.5	5,6	6,4	7,2	6,7	10,1	13,4	16,8	76	45

SPRAYBALLS

Clip coupling 40.5x38.5

Type	Diam (mm)	Coupl. Ext/Int	Holes diam (mm)	Capacity with different Pressure m3/h bar				Range (m)				H (mm) Sprayball plus coupling	No of holes
				1.0	1.5	2.0	2.5	1.0	1.5	2.0	2.5		
2A	65	40.5x38.5	2.5	18.8	22,4	25,8	28,9	2,6	4,6	6,1	7,6	94	109
2B	65	40.5x38.5	2.5	8.4	10,0	11,5	12,9	2,0	3,3	4,4	5,4	94	49
2C	65	40.5x38.5	2.5	11.2	13,3	15,4	17,2	3,7	6,1	8,1	10,0	94	61
2D	65	40.5x38.5	2.5	10.2	12,2	14,0	15,7	3,0	4,9	6,5	8,1	94	59
4A	50	40.5x38.5	1.6	6.6	8,0	9,3	10,4	1,9	2,9	3,9	4,8	78	61
4B	50	40.5x38.5	1.6	4.0	4,8	5,6	6,3	2,8	4,3	5,7	7,1	78	21
4C	50	40.5x38.5	1.6	3.7	4,5	5,2	5,8	2,3	3,5	4,7	5,8	78	41
4D	50	40.5x38.5	1.6	3.9	4,7	5,5	6,1	2.6	4,0	5,3	6,6	78	34

SPRAYBALLS

Clip coupling 42.4x1.6

Type	Diam (mm)	Coupl. Ext/Int	Holes diam (mm)	Capacity with different Pressure m3/h bar				Range (m)				H (mm) Sprayball plus coupling	No of holes
				1.0	1.5	2.0	2.5	1.0	1.5	2.0	2.5		
5A	65	42.4x1.6	2.5	18.8	22,4	25,8	28,9	2,6	4,6	6,1	7,6	92	109
5B	65	42.4x1.6	2.5	8.4	10,0	11,5	12,9	2,0	3,3	4,4	5,4	92	49
5C	65	42.4x1.6	2.5	11.2	13,3	15,4	17,2	3,7	6,1	8,1	10,0	92	61
5D	65	42.4x1.6	2.5	10.2	12,2	14,0	15,7	3,0	4,9	6,5	8,1	92	59

SPRAYBALLS

Clip coupling 32.0x30.0

Type	Diam (mm)	Coupl. Ext/Int	Holes diam (mm)	Capacity with different Pressure m3/h bar				Range (m)				H (mm) Sprayball plus coupling	No of holes
				1.0	1.5	2.0	2.5	1.0	1.5	2.0	2.5		
6A	65	32x30	2.5	18,0	22,3	25,8	28,9	2,4	3,7	5,0	6,2	91	121
6B	65	32x30	2.5	9.30	11,5	13,3	14,9	2,5	3,9	5,2	6,5	91	61
6C	65	32x30	2.5	10.5	13,0	15,1	16,9	3,2	4,9	6,7	8,3	91	61
6D	65	32x30	2.5	10.1	12,5	14,5	16,2	3,0	4,6	6,3	7,8	91	66

SPRAYBALLS

Clip coupling 38.0x36.0

Type	Diam (mm)	Coupl. Ext/Int	Holes diam (mm)	Capacity with different Pressure m3/h bar				Range (m)				H (mm) Sprayball plus coupling	No of holes
				1.0	1.5	2.0	2.5	1.0	1.5	2.0	2.5		
7A	65	38X36	2.5	18.3	22,4	25,8	28,9	3,0	4,6	6,1	7,6	94	109
7B	65	38X36	2.5	8.1	9,9	11,4	12,8	2,4	3,7	4,9	6,1	94	49
7C	65	38X36	2.5	11.6	14,2	16,4	18,3	4,9	7,5	10,0	12,4	94	61
7D	65	38X36	2.5	10.4	12,7	14,7	16,4	3,9	6,0	7,9	9,9	94	59
12A	90	38X36	2.5	24.2	27,4	31,6	35,3	2,0	2,6	3,5	4,3	120	199
12B	90	38X36	2.5	13.4	15,2	17,5	19,5	2,4	3,1	4,2	5,2	120	91
12C	90	38X36	2.5	15.9	18,0	20,8	23,2	3,4	4,4	6,0	7,3	120	109
12D	90	38X36	2.5	14.2	16,1	18,5	20,7	2,8	3,6	4,9	6,0	120	94

SPRAYBALLS

Clip coupling 60.3X52.8

Type	Diam (mm)	Coupl. Ext/Int	Holes diam (mm)	Capacity with different Pressure m3/h bar				Range (m)				H (mm) Sprayball plus coupling	No of holes
				1.0	1.5	2.0	2.5	1.0	1.5	2.0	2.5		
14A	120	60.3X52.8	2	19.0	22,3	25,8	28,9	2,0	3,1	4,1	5,1	150	208
14B	120	60.3X52.8	2	10.2	12,0	13,9	15,5	2,3	3,6	4,7	5,9	150	109
14C	120	60.3X52.8	2	8.90	10,4	12,1	13,5	1,7	2,6	3,5	4,3	150	100
14D	120	60.3X52.8	2	10.0	11,7	13,6	15,2	2,2	3,4	4,5	5,6	150	111

SPRAYBALLS

Clip coupling 28.0x26.0 – Type “J”

Type	Diam (mm)	Coupl. Ext/Int	Holes diam (mm)	Capacity with different Pressure m3/h bar				Range (m)				H (mm) Sprayball plus coupling	No of holes
				1.0	1.5	2.0	2.5	1.0	1.5	2.0	2.5		
1AJ	65	28X26	1,6	8,8	10,7	12,4	13,9	3,4	5,1	6,8	2,5	91	121
1BJ	65	28X26	1,6	5,3	6,4	7,5	8,4	4,9	7,4	9,8	12,3	91	61
1CJ	65	28X26	1,6	5,5	6,7	7,8	8,7	5,3	8,0	10,6	13,3	91	61
1DJ	65	28X26	1,6	5,3	6,4	7,5	8,4	5,0	7,5	10,0	12,5	91	66

SPRAYBALLS

Clip coupling 40.5x38.5 – Type “J”

Type	Diam (mm)	Coupl. Ext/Int	Holes diam (mm)	Capacity with different Pressure m3/h bar				Range (m)				H (mm) Sprayball plus coupling	No of holes
				1.0	1.5	2.0	2.5	1.0	1.5	2.0	2.5		
2AJ	65	40.5x38.5	1,6	10,5	12,9	14,9	16,7	6	9,1	12,1	15,2	94	109
2BJ	65	40.5x38.5	1,6	5,2	6,4	7,4	8,3	2,0	3,3	4,4	5,4	94	49
2CJ	65	40.5x38.5	1,6	8,1	10,0	11,5	12,9	7,4	11,2	14,9	18,7	94	61
2DJ	65	40.5x38.5	1,6	7,7	9,5	10,9	12,2	6,9	10,5	13,9	17,5	94	59

SPRAYBALLS

Female gas thread – Type “J”

Type	Diam (mm)	Coupl. poll	Holes diam (mm)	Capacity with different Pressure m3/h bar				Range (m)				H (mm) Sprayball plus coupling	No of holes
				1.0	1.5	2.0	2.5	1.0	1.5	2.0	2.5		
3AJ	65	¾	1,6	8,4	10,3	11,9	13,4	3,2	4,7	6,3	7,9	94	121
3BJ	65	¾	1,6	4,1	5,0	5,8	6,5	3,0	4,4	5,9	7,4	94	61
3CJ	65	¾	1,6	4,4	5,4	6,2	7,0	3,4	5,0	6,7	8,4	94	61
3DJ	65	¾	1,6	4,4	5,4	6,2	7,0	3,3	4,8	6,5	8,1	94	66

SPRAYBALLS

Clip coupling 42.4x1.6 – Type “J”

Type	Diam (mm)	Coupl. Ext/Int	Holes diam (mm)	Capacity with different Pressure m3/h bar				Range (m)				H (mm) Sprayball plus coupling	No of holes
				1.0	1.5	2.0	2.5	1.0	1.5	2.0	2.5		
5AJ	65	42.4x1.6	2.5	10,5	12,9	14,9	16,7	6	9,1	12,1	15,2	92	109
5BJ	65	42.4x1.6	2.5	5,2	6,4	7,4	8,3	2,0	3,3	4,4	5,4	92	48
5CJ	65	42.4x1.6	2.5	8,1	10,0	11,5	12,9	7,4	11,2	14,9	18,7	92	61
5DJ	65	42.4x1.6	2.5	7,7	9,5	10,9	12,2	6,9	10,5	13,9	17,5	92	59

SPRAYBALLS

Clip coupling 32.0x30.0 – Type “J”

Type	Diam (mm)	Coupl. Ext/Int	Holes diam (mm)	Capacity with different Pressure m3/h bar				Range (m)				H (mm) Sprayball plus coupling	No of holes
				1.0	1.5	2.0	2.5	1.0	1.5	2.0	2.5		
6AJ	65	32x30	1,6	7,9	9,7	11,2	12,5	2,8	4,1	5,5	6,9	91	121
6BJ	65	32x30	1,6	4,2	5,2	6,0	6,6	3,1	4,5	6,1	7,6	91	61
6CJ	65	32x30	1,6	4,3	5,3	6,1	6,8	3,3	4,8	6,5	8,1	91	61
6DJ	65	32x30	1,6	4,3	5,3	6,1	6,8	3,2	4,7	6,3	7,9	91	66

SPRAYBALLS

Clip coupling 38.0x36.0 – Type “J”

Type	Diam (mm)	Coupl. Ext/Int	Holes diam (mm)	Capacity with different Pressure m3/h bar				Range (m)				H (mm) Sprayball plus coupling	N° holes
				1.0	1.5	2.0	2.5	1.0	1.5	2.0	2.5		
7AJ	65	38X36	1,6	11,2	13,7	15,8	17,7	6,8	10,2	13,7	17,1	94	109
7BJ	65	38X36	1,6	6,4	7,8	9,0	10,1	8,9	13,4	17,9	22,4	94	49
7CJ	65	38X36	1,6	8,3	10,2	11,7	13,1	9,1	13,7	18,3	22,9	94	61
7DJ	65	38X36	1,6	7,8	9,5	11,0	12,3	8,8	13,2	17,7	22,1	94	59

MAINTENANCE

Sprayballs do not need any specific maintenance.

In order to increase the product's life, please use the optimal flow and pressure values, as indicated in the product specific data tables. Temperature should not exceed 90° Celsius. Also, mounting the sprayballs in a vertical position will increase their duration, compared to a horizontal or oblique position (45° / 60°). Please use the sprayballs only with filtered liquids, without any impurity or any solid particle in suspension. We suggest to dismount the sprayballs after every washing cycle.

Our sprayballs are made in AISI316L steel, which allows to use them with liquids for human consumption .

WARRANTY

The products are replaced or repaired, following decision of the producer, with no expense for the customer, in case of parts that are faulty from the origin. The warranty is valid if the defect is notified through mail within 30 days from its installation, or within a year from the delivery date. The cost of the replacement or repair of the item is the only expenditure that can be charged to our company, that cannot be held responsible for damages to persons or things, nor for trade losses due to the non-working conditions of our products.

In order to improve our products we continuously enhance our products, therefore shapes, dimensions and characteristics of our products, as shown or written in this catalog, may be changed without prior notice.



TASSALINI S.P.A.

Via G. Di Vittorio 19/21 | 20068 Peschiera Borromeo (MI) | Italy

t +39 02 55 38 311 | f +39 02 54 73 441 | info@tassalini.it | www.tassalini.com